

EN Operating instructions



FEX-PRO

EN Fume extraction system



SCAN FOR MORE



Table of contents

1 Identification	4
1.1 Signs and symbols used	4
1.2 Classification of the warnings	5
1.3 Product label	5
2 Safety	6
2.1 Designated use	6
2.2 Obligations of the operator	6
2.2.1 Country-specific obligations of the operator	7
2.3 Warnings and notice signs	7
2.4 Safety instructions	8
2.4.1 Basic safety instructions	8
2.4.2 Safety instructions for electrical components	8
2.4.3 Safety instructions for welding	8
2.4.4 Safety instructions for personal protective equipment	9
2.4.5 Safety instructions for fume extraction	9
2.4.6 Safety instructions for emergencies	9
3 Scope of delivery	10
4 Product description	11
4.1 Assembly and use	11
4.2 Control elements and connections	12
5 Technical data	13
5.1 Ambient Conditions	13
5.2 Product data	13
6 Transport and installation	14
7 Putting Into Operation	15
7.1 Attaching the extraction hose	15
7.2 Mounting the Current Clamp	16
7.3 Establishing the power supply	16
8 Operation	17
8.1 Setting the extraction volume	17
8.2 Start extraction in manual mode	18
8.3 Start extraction in automatic mode	18
9 Putting Out of Operation	19

10 Maintenance and cleaning	20
10.1 Maintenance and Cleaning Intervals	21
10.2 Clean filter cartridge.....	22
10.3 Empty the dust collecting container.....	24
10.4 Change the filter cartridge.....	25
10.5 Change main filter	27
11 Faults and their Correction	28
12 Disassembly	29
13 Disposal.....	30
13.1 Disposal of materials	30
13.2 Disposal of consumables.....	30
13.3 Disposing of packaging	30
13.4 Disposal of welding dust.....	30

1 Identification

This operating manual describes the fume extraction unit FEX-PRO. The terms "unit", "product" and "fume extraction unit" used in this operating manual always all stand for the fume extraction unit FEX-PRO.

The unit is used for extracting welding, cutting and grinding fumes.

Further information and additional documentation for the product can be found in the download portal at www.abidoc.binzel-abicor.com.

1.1 Signs and symbols used

In these operating instructions, the following signs and symbols are used:

▶	General instructions.
1.	Steps to be carried out in succession.
-	Lists.
⇒	The cross-reference refers to detailed, supplementary or further information.
A	Caption, item description.

1.2 Classification of the warnings

The warning notices used are divided into four different levels and are printed in front of potentially dangerous work steps.

Depending on the type of danger, the following signal words are used:

 DANGER	
	<p>Describes an imminent danger.</p> <p>Will result in death or serious injuries if not avoided.</p>
 WARNING	
	<p>Describes a potentially dangerous situation.</p> <p>May result in death or serious injuries if not avoided.</p>
 CAUTION	
	<p>Describes a potentially damaging situation.</p> <p>May result in slight or minor injuries if not avoided.</p>
NOTE	
	<p>Describes possible property damage.</p> <p>If the notice is not followed, irreparable damage to the product or equipment can be the result. Work results may be impaired.</p>

1.3 Product label

This product fulfills the requirements that apply to the market to which it has been introduced. A corresponding marking has been affixed to the product, if required.

2 Safety

This chapter describes the essential safety requirements and warns of residual hazards that should be kept in mind to operate the product safely. Non-observance of the safety instructions may result in risks to the life and health of personnel as well as cause environmental or material damage.

2.1 Designated use



The unit is used to extract fumes and dust that result from welding, grinding, and thermal cutting processes. The unit can be used for extraction during welding, grinding or cutting steel with a nickel and chrome alloy content less than 30 %.

The unit must not be used for extracting welding fumes that contain CMR substances.

The device may be used only for the purpose and in the manner described in this documentation. Any other use is considered non-intended. Unauthorized conversion work or modifications to increase performance are not permissible.

- ▶ Only operate the unit with original ABICOR BINZEL spare parts.
- ▶ Do not exceed the maximum load data given in the documents. Excess loads will lead to irreparable damage.
- ▶ Do not make constructional changes to the unit.
- ▶ Do not use or store the unit in wet conditions.
- ▶ Only use the unit outdoors when sufficiently protected against the influences of the weather.
- ▶ Note that the volume flow routed back into the workspace must not exceed 50 % of the supply air to the installation room. With free room ventilation, a supply air flow of one times the room volume per hour can be assumed. This means an air exchange rate of one per hour (supply air flow [m³/h] = room volume [m³] × air exchange rate [1/h]).
- ▶ Check the extraction hoses for damage and soiling at regular intervals, but at least once every week.

2.2 Obligations of the operator

 WARNING	
	<p>Risk of injury due to electromagnetic fields</p> <p>The device can cause electromagnetic fields to develop.</p> <ul style="list-style-type: none"> ▶ Use the device only in industrial areas.

- ▶ Keep non-suitably qualified people out of the work area.
- ▶ Ensure that only suitably qualified personnel perform work on the device or system.

Suitably qualified personnel are:

- those who are familiar with the basic regulations on occupational safety and accident prevention;
- those who have been instructed on how to handle the device;
- those who have read and understood all related documentation;
- those who have been trained accordingly;
- those who are able to recognize possible risks because of their special training, knowledge, and experience.

2.2.1 Country-specific obligations of the operator





In some countries returning filtered air to the installation room is prohibited on account of residual health risks.

- ▶ Observe the local health & safety requirements.
- ▶ Observe the local regulations for fume extraction systems, as these may require regular inspections by authorized agencies or the re-issue of certificates of compliance or equivalent certificates.

2.3 Warnings and notice signs

The following warning, notice and mandatory signs can be found on the product.

These markings must always be legible. They may not be covered, obscured, painted over, or removed.

	▶ Read and follow the operating manual.
	▶ Wear a respiratory mask.
	▶ Wear protective gloves.
	▶ Wear safety goggles.
	<p>Damage to material due to electrostatic discharge on contact.</p> <p>▶ Have the device grounded by a qualified electrician before startup.</p>

2.4 Safety instructions

2.4.1 Basic safety instructions

The device has been developed and manufactured in accordance with the latest technology and recognized safety standards and directives. Due to the device design, unavoidable technical residual risks exist to the user, third parties, devices, and other material property. The manufacturer will accept no liability for damage caused by non-observance of the documentation.

- ▶ Please read the documentation carefully before using the product for the first time and comply with the instructions contained.
- ▶ Only operate the device in technically perfect condition and ensure compliance with all documentation.
- ▶ Read the documentation carefully before carrying out specific work, for example, commissioning, operation, transport, and maintenance.
- ▶ Use suitable means to protect yourself and bystanders from the hazards listed in the documentation.
- ▶ Store the documentation within easy reach of the device for reference and enclose all documents when passing on the device.
- ▶ Consult the documentation for the other components used.
- ▶ Information about how to handle gas cylinders can be found in the instructions provided by the gas manufacturer and the relevant local regulations, e.g., the Pressure Equipment Directive.
- ▶ Disconnect the power supply and shut off the gas and compressed air supply for the entire duration of maintenance, servicing and repair work.
- ▶ Observe the local accident prevention regulations.
- ▶ Only trained specialists should commission, operate, and service the device. Qualified personnel are persons who, based on their special training, knowledge, experience and due to their knowledge of the relevant standards, are able to assess the tasks assigned to them and identify possible dangers.
- ▶ Ensure the work area is well lit and keep it neat and tidy.
- ▶ For disposal, observe the local regulations, laws, provisions, standards, and directives.

2.4.2 Safety instructions for electrical components

- ▶ Check electric tools for damage and ensure that they function properly and in accordance with their designated use.
- ▶ Do not expose electric tools to rain and avoid a moist or wet environment.
- ▶ Protect yourself from electric shock by using insulating mats and wearing dry clothing.
- ▶ Do not use the electric tools in areas subject to fire or explosion hazards.

2.4.3 Safety instructions for welding

- ▶ Arc welding can damage eyes, skin and hearing. Note that further hazards can occur in connection with other welding components. For this reason, always wear the mandatory protective clothing in accordance with local laws and directives.
- ▶ All metal vapors, especially lead, cadmium, copper and beryllium, are harmful. Ensure sufficient ventilation or extraction. Do not exceed the established occupational exposure limit (OEL).
- ▶ To prevent phosgene gas from forming, always use clear water to rinse workpieces that have been degreased using chlorinated solvents. Do not set up degreasing baths containing chlorine near the welding station.
- ▶ Adhere to the general fire protection regulations and remove flammable materials from the vicinity of the welding work area prior to starting work. Provide suitable fire extinguishing equipment in the work area.

2.4.4 Safety instructions for personal protective equipment

- ▶ Do not wear any loose clothing or jewelry.
- ▶ Wear a hairnet over long hair.
- ▶ Note local laws and directives concerning protective equipment.
- ▶ Make sure that any third parties in the direct vicinity are wearing personal protective equipment.
- ▶ Wear your personal protective equipment according to the hazard.

2.4.5 Safety instructions for fume extraction

From the first time it is used, the unit contains harmful dust that can settle on surfaces and get into the ambient air. It can damage the respiratory system when inhaled.

- ▶ Check and wear your personal protective equipment.
- ▶ Only use the unit in rooms which are sufficiently ventilated.
- ▶ Make sure that all the seals on the unit are free of dirt.
- ▶ Always only operate the unit with the designated filters.
- ▶ Remove dust deposits in the surrounding area immediately using an industrial vacuum cleaner of dust class H or a damp cloth.

The extraction of substances and materials which are combustible, aggressive, chemical or contain oil vapors as well as aluminum or magnesium dusts can lead to fire and explosion due to chemical reactions. Serious injuries and irreparable damage to the unit can be the result.

- ▶ Only ever use the unit as intended.

2.4.6 Safety instructions for emergencies

- ▶ In an emergency, immediately disconnect all supplies (e.g. electrical power supply, coolant supply, compressed air supply, shielding gas supply).
- ▶ Extinguish burning oil or emulsions using a CO₂ or powder fire extinguisher.

3 Scope of delivery

The following components are included in the scope of delivery:

- 1 × FEX-PRO fume extraction system
- ▶ Order the equipment parts and wear parts separately.
- ▶ The order data for the equipment parts and wear parts can be found in the current order documents.
- ▶ For more information about points of contact, consultation, and orders, visit www.binzel-abicor.com.

Although the items delivered are carefully checked and packaged before dispatch, it is not possible to fully exclude the risk of transport damage.

Goods-in inspection

- ▶ Use the delivery note to check that everything has been delivered.
- ▶ Check the delivery for damage (visual inspection).

Complaints

- ▶ If goods are damaged, contact the final carrier.
- ▶ Keep the packaging for a possible check by the carrier.

Returns

- ▶ Use the original packaging and packing material for returns.
- ▶ If you have questions concerning packaging and safety during shipment, contact your supplier, carrier, or transport company.

4 Product description

4.1 Assembly and use

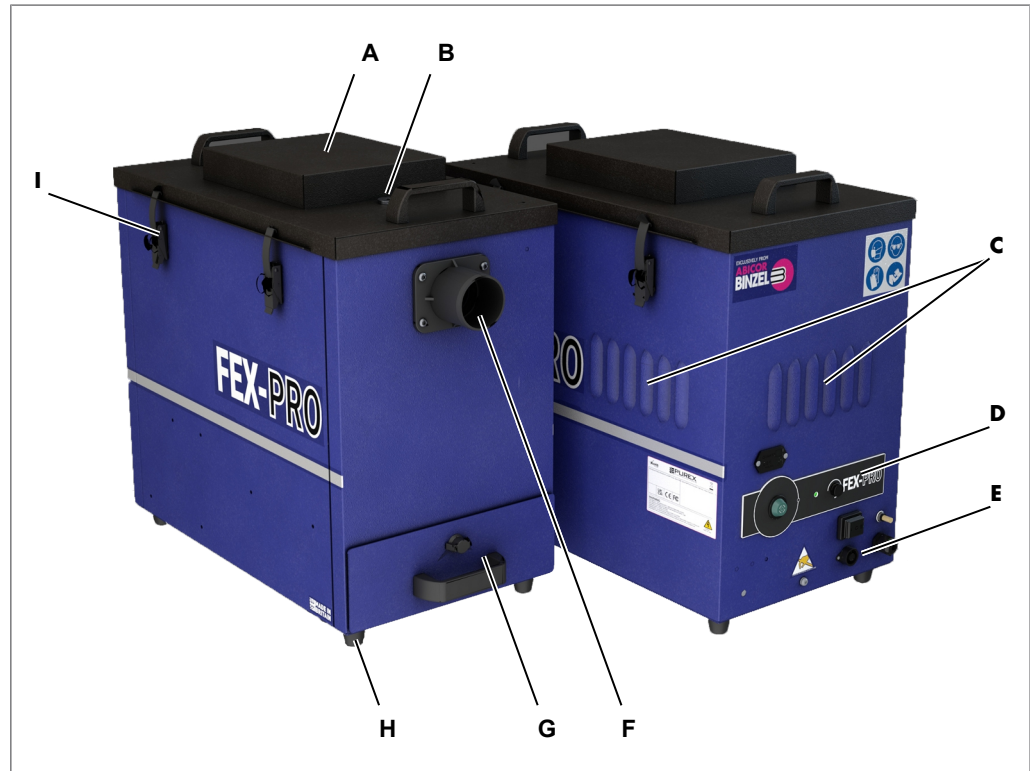

Figure 1 Assembly and use

A	Filter cartridge	B	Compressed air connection
C	Exhaust air	D	Control elements
E	Electrical connections	F	Intake nozzles
G	Dust collecting container	H	4× foot
I	4x tension locks		

The device is a component of a welding system. The device is used for manual welding. Welding produces welding fumes that are hazardous to health; they are filtered and cleaned by the device's internal filters.

The device can be used to extract fumes and dust when welding or cutting steel with an alloy content of nickel and chrome under 30%.

The welding fumes are fed into the middle section of the unit through the intake nozzle. When this occurs, the welding fumes are drawn through the filter cartridge and the main filter. The filter membranes trap the dirt particles. Then the cleaned air is returned to the environment via the air outlet.

The unit can be equipped optional with an automatic start-stop feature.

Used together with a connected clamp-on ammeter, the automatic start-stop feature makes it possible to switch the extractor on automatically when the welding process starts (automatic mode). Once the welding process begins, the device receives a signal from the current clamp and automatically starts the fume extraction process. Use of the automatic start/stop mechanism extends the service life of the device and noise pollution and energy consumption are reduced.

The following fume extraction devices can be connected to the device:

- Fume extraction torch
- Welding torch with external fume extraction systems
- Funnel-shaped nozzle with magnetic bracket

4.2 Control elements and connections



Figure 2 Control elements

1	Hour meter	2	Start button
3	Service LED	4	Output regulator
5	Circuit breaker reset	6	Power supply cable
7	<Auto/Manual> Schalter	8	Current clamp port

<Auto/Manual> switch	The automatic start/stop mechanism is activated when the switch is set to <II>. If the switch is set to <I>, the automatic start/stop mechanism is inactive and the device must be switched on and off manually.
Hour meter	The hour meter counts the operating hours and can be used to determine the maintenance intervals.
Service LED	There is a safety device for monitoring the minimum air volume to be extracted installed in the unit. Monitoring is carried out by a differential pressure switch. The service LED illuminates in orange and an acoustic signal sounds continuously when both filter cartridges are not functioning properly or are saturated and must be replaced.

5 Technical data

5.1 Ambient Conditions

Temperature of the ambient air	-10 °C to +50 °C
Relative air humidity	Up to 90% at +20 °C

Table 1 Ambient conditions for transport and storage

Temperature of the ambient air	+10 °C to +50 °C
Relative air humidity	Up to 90% at +20 °C
Max. site altitude	1000 m above sea level

Table 2 Ambient conditions for operation

5.2 Product data

	FEX-PRO
Mains voltage	110 to 230 V
Mains frequency	50 Hz / 60 Hz
Mains fuse	16 A
Drive capacity	1.1 kW
Filter class filter cartridge	M
Filter area filter cartridge	0.8 m ²
Filter class main filter	HEPA H14
Filter area main filter	1.52 m ²
Degree of separation main filter	99.997 % (particles up to 0.3 µm) and 95 % (particles up to 0.01 µm)
Connection diameter extraction hose	50 mm
Max. air volume flow	200 m ³ /h
Max. vacuum	23000 Pa
Type of vacuum generator	Tangential discharge blower
Weight	20 kg (44 lbs)
Dimensions	573 mm x 305 mm x 527 mm (22.5 in x 12 in x 20.7 in)
Sound pressure level LpA	< 60 dB (A)

Table 3 Product data

- Obtain the volume flow to be provided at the connector to achieve the actual induced speed according to DIN EN ISO 21904 V_i from the operating instructions of the corresponding fume extraction device.

6 Transport and installation**⚠ WARNING****Risk of injury due to improper transport and setup**

Improper transport and setup can lead to the unit tilting or falling. Serious injuries can be the result.

- ▶ Check and wear your personal protective equipment.
- ▶ Place the unit on a suitable base (level, firm, dry) so that it cannot tilt over.
- ▶ Take the weight of the unit into account when lifting the unit. ⇨ 5 *Technical data* (Page 13)
- ▶ Use suitable lifting gear with load-handling attachments to transport and set up the unit.
- ▶ Avoid jerky lifting and set-down of the unit.
- ▶ Do not lift the unit over people or other units.

NOTE**Property damage due to improper transport and setup**

Improper transport or setup can lead to the unit tilting or falling. Property damage and irreparable damage to the unit can be the result.

- ▶ Protect the unit against influences of the weather e.g. rain and direct sunlight.
- ▶ When driving over edges make sure that the unit does not become caught.
- ▶ Only use the unit in dry, clean and well ventilated rooms.
- ▶ When setting the unit up, keep a minimum clearance of 1 m to the wall so that the unit is sufficiently ventilated.

7 Putting Into Operation

7.1 Attaching the extraction hose

Extraction hoses are not included in the scope of delivery and must be ordered separately.

NOTE



Insufficient cleaning due to faulty connection of the extraction hose

Improper connection of the extraction hose it can become blocked. The result may be insufficient extraction and expansion of fume.

- ▶ Do not reduce the diameter of the hose.
- ▶ Use the shortest length of hose possible.
- ▶ Lay the hose without kinks.

1. Screw the connectors on both ends of the extraction hose.



2. Connect one end of the extraction hose to the connection on the cable assembly of the fume extraction device (e.g. fume extraction torch).

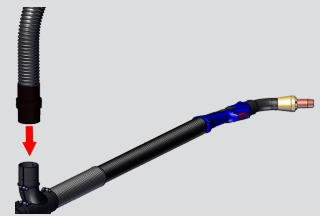

3. Connect the other end of the extraction hose with intake nozzle to the unit.



7.2 Mounting the Current Clamp

The Current clamp is not included in the scope of delivery. It can be purchased optionally.

- If the current clamp is not used, close the connection with the screw-on cap.

1. Connect the current clamp cable to the current clamp port.



2. Lay the current clamp over the cable assembly and ensure that the red point on the current clamp always points in the direction of the current flow.

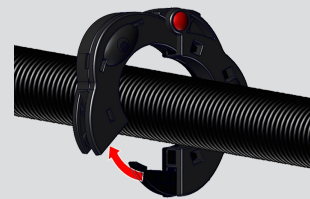

7.3 Establishing the power supply

- Note the safety instructions. Safety instructions for the electrical power supply

⚠ WARNING



Electric shock due to damaged or improperly installed cable

The use of damaged or improperly installed cables may result in a potentially fatal electric shock.

- Check all live cables and connections for proper installation and damage.
- Have any damaged, deformed, or worn parts replaced by a qualified electrician only.

⚠ WARNING



Fire hazard due to improper mains connection

A fire can be caused by an improper mains connection. Serious burns can be the result.

- Make sure that the operating voltage stated on the rating plate matches the mains voltage.

For mains connection and fuse protection, see:

⇒ 5 Technical data (Page 13)

The mains plug is mounted on the power supply cable.

- Plug in the mains plug.

8 Operation

⚠ WARNING**Health risk due to inhalation of harmful welding, grinding, and cutting fumes**

Welding, grinding and thermal cutting processes produce fumes containing harmful dust particles that can settle on surfaces and be released into the ambient air. The respiratory system can be damaged if inhaled.

- ▶ Check and wear your personal protective equipment.
- ▶ Only use the unit in rooms which are sufficiently ventilated.
- ▶ Make sure that all the seals on the unit are free of dirt.
- ▶ Always only operate the unit with the designated filtration system.
- ▶ Always only operate the unit with the dust collecting container closed.
- ▶ Do not open the dust collecting container until at least one minute after switching the unit off.
- ▶ Keep the unit closed during operation and the dedusting process.
- ▶ Remove dust deposits in the surrounding area immediately using an industrial vacuum cleaner of dust class H or a damp cloth.

⚠ WARNING**Fire hazard due to improper use**

Improper use of the device can result in fire. This may result in serious burns.

- ▶ Do not use the device in areas subject to dust or gas explosion hazards.
- ▶ Do not use the device to extract welding fumes that result from welding oil-wetted parts.
- ▶ Do not use the device to extract flammable substances and liquids.

8.1 Setting the extraction volume

An unnecessarily high speed shortens the service life of the filters.

1. To adjust the extraction volume, turn the output regulator to the left or right .



8.2 Start extraction in manual mode

The device is operated in manual mode (deactivated automatic start/stop mechanism) as follows:

1. Set the <Auto/Manual> switch to <I>.



2. Press start button.

Continuous extraction is started and the start button illuminates.

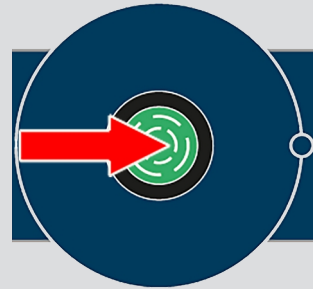

8.3 Start extraction in automatic mode

The device is operated in automatic mode (activated automatic start/stop mechanism) as follows:

1. Lay the current clamp over the cable assembly and ensure that the red point on the current clamp always points in the direction of the current flow..

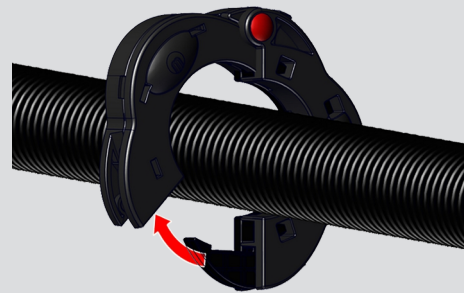

2. Set the <Auto/Manual> switch to <II>.



3. Press the start button.

The start button illuminates. Once the welding process begins, the device receives a signal from the current clamp and automatically starts the fume extraction process.

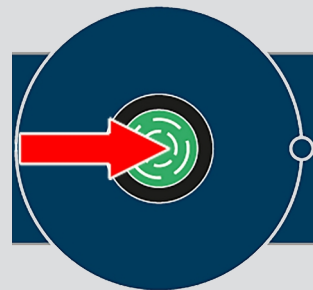

9 Putting Out of Operation

1. Stop the welding process.

2. Press start button.

The start button does not illuminate.

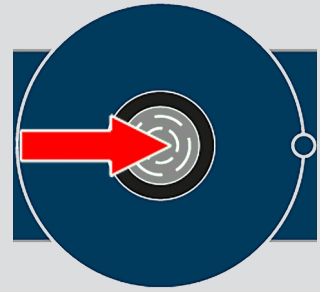

3. Set the <Auto/Manual> switch <0>.



4. Remove the current clamp from the cable assembly.

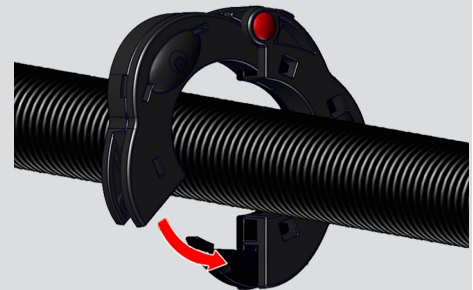

5. Disconnect the unit from the power supply.

6. Detach the extraction hose.

10 Maintenance and cleaning

Regular maintenance and cleaning are prerequisites for a long service life and perfect function. The regular removal of dust can extend the service life of the filter cartridges. The maintenance interval is determined by the working environment and operating time of the units. If the unit is operated for longer than 8 hours per day, the maintenance interval should be adapted according to requirements.

WARNING



Health risk due to inhalation of harmful welding, grinding, and cutting fumes

Welding, grinding and thermal cutting processes produce fumes containing harmful dust particles that can settle on surfaces and be released into the ambient air. The respiratory system can be damaged if inhaled.

- ▶ Check and wear your personal protective equipment.
- ▶ Only use the unit in rooms which are sufficiently ventilated.
- ▶ Make sure that all the seals on the unit are free of dirt.
- ▶ After cleaning and maintenance work check all screwed joints for a tight fit, leaks, chafing points. Tighten any loosened screwed joints. Correct any faults found immediately.
- ▶ Remove dust deposits in the surrounding area immediately using an industrial vacuum cleaner of dust class H or a damp cloth.

WARNING



Electric shock due to damaged or improperly installed cable

The use of damaged or improperly installed cables may result in a potentially fatal electric shock.

- ▶ Check all live cables and connections for proper installation and damage.
- ▶ Have any damaged, deformed, or worn parts replaced by a qualified electrician only.

WARNING



Risk of crushing

Improper assembly and disassembly of unit components can crush limbs.

- ▶ Do not reach into the danger zone.
- ▶ Check and wear your personal protective equipment.

CAUTION



Risk of injury due to unexpected start

If power is supplied during maintenance, cleaning or disassembly, rotating parts can start running unexpectedly and lead to injuries from cuts.

- ▶ Switch off the device.
- ▶ Disconnect all electrical connections.

10.1 Maintenance and Cleaning Intervals

The given intervals are for guidance and refer to one-shift operation. We recommend documenting the checks. At least the test date, the defects found and the name of the tester should be documented.

Interval	Job
After 2 operating hours or when the service LED illuminates	<ul style="list-style-type: none"> ▶ Clean filter cartridge. ⇒ 10.2 Clean filter cartridge (Page 22)
Daily	<ul style="list-style-type: none"> ▶ Check that the welding fumes are properly drawn into the fume extraction device. ▶ Run the cleaning process.
Daily	<ul style="list-style-type: none"> ▶ Empty the dust collection container. ⇒ 10.3 Empty the dust collecting container (Page 24)
Monthly	<ul style="list-style-type: none"> ▶ Check the device for visible damage.
Semiannually	<ul style="list-style-type: none"> ▶ Check the fume extraction device, extraction hose and intake nozzles for deposits and blockages before changing the filter. ▶ Change the filter cartridge. ⇒ 10.4 Change the filter cartridge (Page 25) ▶ Change main filter. ⇒ 10.5 Change main filter (Page 27)
Yearly	<ul style="list-style-type: none"> ▶ Change filter cartridge and main filter. ⇒ 10.4 Change the filter cartridge (Page 25), ⇒ 10.5 Change main filter (Page 27) ▶ Carry out all maintenance. ▶ If necessary, have regular inspections carried out by authorized person or re-issue certificates of compliance or equivalent certificates in accordance with local regulations.

Table 4 Maintenance and Cleaning Intervals

10.2 Clean filter cartridge

NOTE



Insufficient extraction due to damage to the filter elements

Improper cleaning can damage the filter elements. This can result in inadequate extraction.

- ▶ Observe the information on compressed air quality. ⇨ 5 *Technical data* (Page 13)
- ▶ The filter should be cleaned at least once per work shift, depending on how often the system is used.
- ▶ Clean the filter immediately when the service LED lights up on the control panel.

1. Connect the compressed air supply.



2. Open the valve lever on the compressed air connection.



3. Manually move the cleaning lance up and down multiple times.

The filter cartridge is cleaned by manually moving the cleaning lance up and down. The compressed air introduced escapes via the exhaust air.

4. Close the valve lever on the compressed air connection.



5. After the system has been cleaned, disconnect the compressed air supply from the device again.



6. Check that the sealing cap on the connection for the exhaust air hose is properly closed again, otherwise the extraction power will be impaired.

10.3 Empty the dust collecting container

1. Loosen the screw on the dust collecting container.

2. Pull out the dust collecting container.

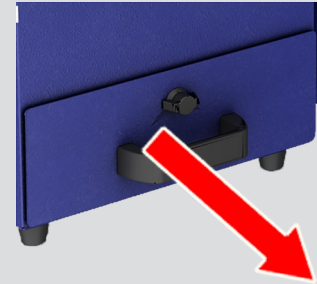

3. Empty the dust collection container into the dust collecting bag.



4. Seal the dust collecting bag and dispose of it in accordance with local laws and directives. ⇒ 13.4 Disposal of welding dust (Page 30)

10.4 Change the filter cartridge

1. Loosen the tension locks on both sides.

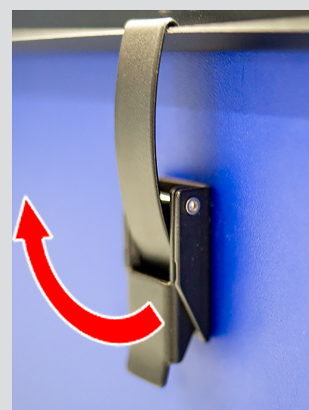

2. Carefully remove the cover with the filter cartridge from the housing.

3. Loosen the earth strap.



4. Remove the nuts on the compression plate.



5. Remove the compression plate and filter cartridge.

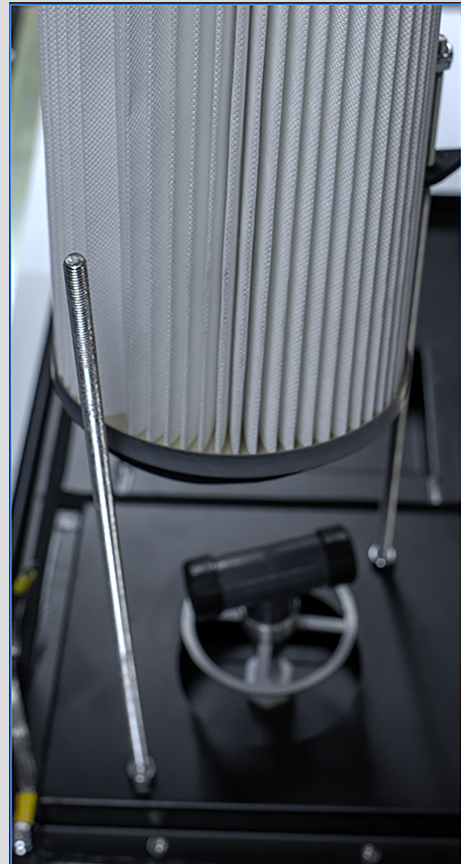

6. Insert a new filter cartridge.
7. Refit the compression plate and earth strap.
8. Attach and lock the cover with the filter cartridge and switch the unit on again.

10.5 Change main filter

The main filter cannot be cleaned; it must be completely replaced.

1. Loosen the tension locks on both sides.



2. Carefully remove the cover with the filter cartridge from the housing.

3. Loosen the earth strap.

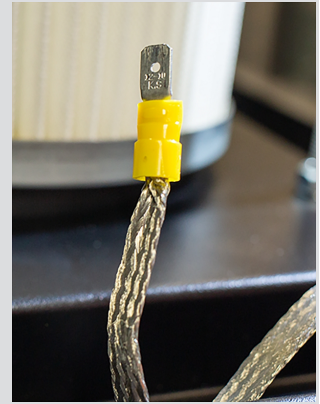

4. Removing the main filter from the housing.



5. Insert the main filter into the housing. Ensure that it is seated correctly in the holder, the air flow arrow must point downwards.

11 Faults and their Correction

- ▶ Consult the documentation of all components used.
- ▶ Contact your retailer or ABICOR BINZEL in the event of questions or problems.

Fault	Cause	Troubleshooting
Extraction volume too low.	Filter elements saturated.	<ul style="list-style-type: none"> ▶ Clean filter cartridge. ⇒ 10.2 Clean filter cartridge (Page 22) ▶ Change the filter cartridge. ⇒ 10.4 Change the filter cartridge (Page 25) ▶ If the extraction volume is still too low, replace the main filter. ⇒ 10.5 Change main filter (Page 27)
	Extraction hose blocked.	▶ Clean the extraction hose.
	Extraction hose faulty.	▶ Replace extraction hose.
	Tension locks not closed properly.	▶ Close tension locks correctly.
	Thermal cut-off of the blower has tripped.	<ul style="list-style-type: none"> ▶ Switch the unit off and allow to cool. ▶ Check exhaust air openings for soiling and clean if necessary.
Extraction system does not start up.	Power supply not OK.	▶ Check and replace as needed, or contact customer service.
	Electrical component faulty.	
	Current clamp is not mounted correctly.	▶ Mount the current clamp properly ⇒ 7.2 Mounting the Current Clamp (Page 16).
Service LED illuminates continuously and an acoustic signal sounds.	Filter cartridge or main filter not OK/saturated.	<ul style="list-style-type: none"> ▶ Clean filter cartridge. ▶ Restart the device. <p>If the service LED remains illuminated:</p> <ul style="list-style-type: none"> ▶ Change filter cartridge and main filter. ⇒ 10.4 Change the filter cartridge (Page 25), ⇒ 10.5 Change main filter (Page 27)

Fault	Cause	Troubleshooting
Odour or dust particles in the exhaust air.	Main filter not OK/saturated.	<ul style="list-style-type: none"> ▶ Check that the main filter is inserted correctly. ▶ Change main filter. ⇨ 10.5 Change main filter (Page 27)

Table 5 Faults and troubleshooting

12 Disassembly

⚠ CAUTION



Risk of injury due to unexpected start

If power is supplied during maintenance, cleaning or disassembly, rotating parts can start running unexpectedly and lead to injuries from cuts.

- ▶ Switch off the device.
- ▶ Disconnect all electrical connections.

1. Remove the current clamp from the cable assembly.

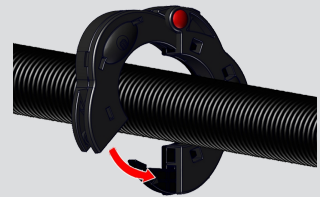

2. Remove the extraction hose.



13 Disposal

13.1 Disposal of materials

This product is mainly made of metallic materials that can be melted in steel and iron works and are thus almost infinitely recyclable. The plastic materials used are labeled in preparation for their sorting and separation for later recycling.

- ▶ Heed local laws and directives on disposal.

13.2 Disposal of consumables

Oil, greases and cleaning agents must not contaminate the ground or enter the sewage system.

- ▶ Store, transport and dispose of consumables in suitable containers.
- ▶ Dispose of contaminated cleaning tools (brushes, rags, etc.) in accordance with the information provided by the consumables' manufacturer.
- ▶ Observe the local laws and regulations on disposal provisions in the safety data sheets of the consumables manufacturer.

13.3 Disposing of packaging

ABICOR BINZEL has reduced the transport packaging to a minimum. The ability to recycle packaging materials was always considered during their selection.

- ▶ Heed local laws and directives on disposal.

13.4 Disposal of welding dust

The disposal of the welding dust and the dust collecting bags is subject to special waste regulations. Welding dust and dust collecting bags must not be disposed of in the sewage system or together with household waste.

- ▶ Heed local laws and directives on disposal.
- ▶ Do not reuse the dust collecting bag.
- ▶ Do not send the dust collecting bag for recycling.



ABICOR BINZEL USA, Inc.
650 Medimmune Ct #110, Frederick, MD 21703
T 301-846-4196
F 301-846-4497
customerservice@abicorusa.com

www.binzel-abicor.com