

Robot Mount "iCAT" & "iSTM"

How to order a Hollow Wrist Cable Assembly

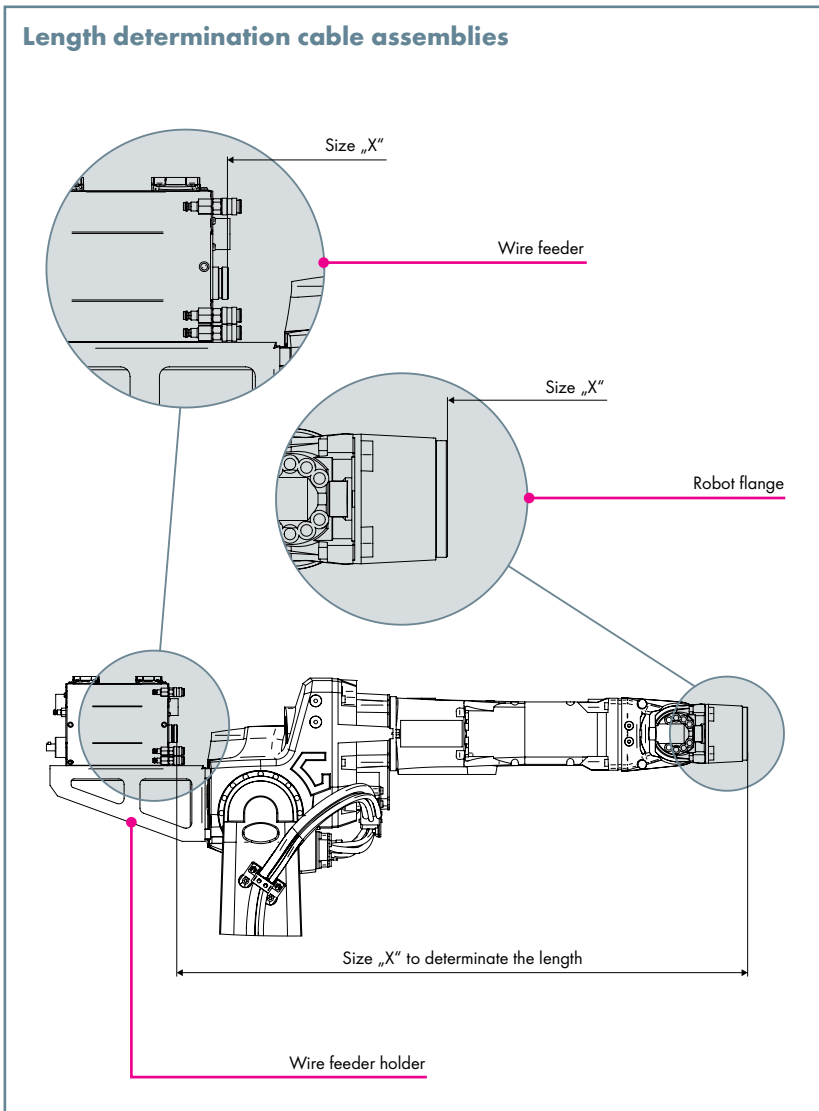

View of machine side connection

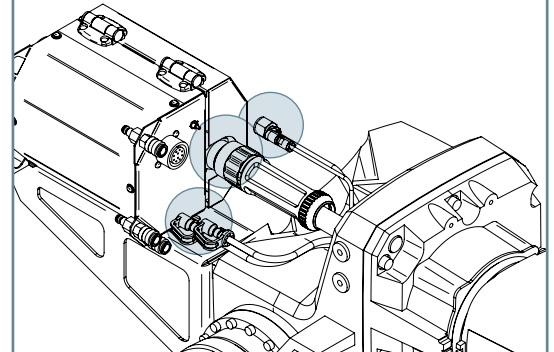

Hint:

Important for the configuration of the cable assembly is the correct indication of connections such as control line connectors, connections for coolant hoses, blowing out and so on.

View of wire feeder holder (view from below)

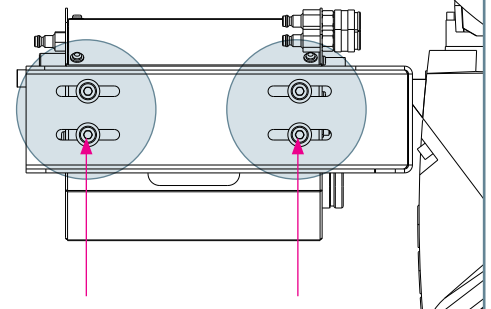

Hint:

For the length determination of the wire feeder it should be positioned in the middle of the elongate holes so that the length of the cable assembly has sufficient flexibility.

Important information for ordering hollow wrist cable assemblies (please fill in):

1. General Information:

Type and manufacturer of the robot:

Type and manufacturer of the wire feeder:

Welding torch system (e.g. ABIROB® A):

Control lines connector (e.g. Amphenol, open, etc. ...):

Size „X“ cable assembly (see above)

2. Desired additional functions:

- Blowing out function
 Gas nozzle sensor
 Wire brake
 Wire feeding button

3. Other information:
